

Narzędzia frezerskie składane - Frezy kuliste

BT96417

Charakterystyka:

Indexable ball nose semi-finishing and finishing cutter equipped with positive insert that provides low cutting forces and reduced vibration. Its accurate pocket ensures that the insert is firmly fixed. Milling cutter equipped with modular shank.

Zastosowanie:

Ball end mill for tool and die applications. This indexable ball nose cutter works well on steels, hardened steels, stainless steels and casts.

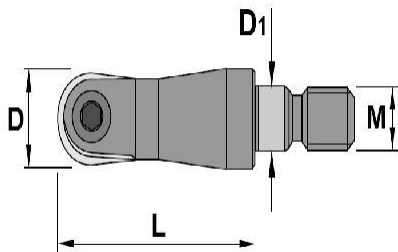

BT96417	D	L	M	D1	Rozmiar płytek	Waga	Cena
BT9641.17-010	10	23	6	6,5	WPR 10	0,1	Cena na telefon
BT9651.17-012	12	30	8	8,5	WPR 12	0,1	Cena na telefon
BT9661.17-016	16	30	8	8,5	WPR 16	0,1	Cena na telefon
BT9671.17-020	20	35	10	10,5	WPR 20	0,1	Cena na telefon
BT9691.17-025	25	40	12	12,5	WPR 25	0,2	Cena na telefon

Gdańska 10
70-660 Szczecin
* Telefon: +48 91 489 63 62
* Telefon: +48 500 189 009
* Fax: +48 91 462 30 00
* E-mail: baltictool@baltictool.com

05-02-2012